

FREDERICK SCHUCHARDT B-4

ADAMS COUNTY

Field: N. CARTHAGE POINT

SECTION: 1 TWN: 6 n RANGE: 4W

LAT: 31.52152 LONG: -91.48120

API #: 23-001-00131

BASE OF USDW@ 990'

MISSISSIPPI STATE OIL AND GAS BOARD
APPLICATION FOR PERMIT TO DRILL, WORKOVER OR CHANGE OPERATOR

200143

APPLICATION TO DRILL

FORM No. 2
WORKOVER

CHANGE OF OPERATOR

NAME OF COMPANY OR OPERATOR Aldridge Operating Company, LLC			DATE 03/01/2014		
ADDRESS P. O. Box 629		CITY Natchez	STATE MS	ZIP 39121	TELEPHONE 601-446-5585
NAME OF WELL Frederick Schuchardt			WELL NO. B-4	ELEVATION (GROUND) 77	
WELL LOCATION (WHEN POSSIBLE, GIVE FOOTAGE FROM SECTION LINES) Fr NE/C of T5N, R4W, go west for 3960', th S for 330' to location			SECTION - TOWNSHIP - RANGE Sec 1, T6N-R4W		
FIELD & RESERVOIR (IF WILDCAT, SO STATE) N. Carthage Point Field/Wilcox			API No. (EXISTING WELL) 23-001-00131		APPROX. DATE WORK BEGINS
PROPOSED DEPTH	PROPOSED LENGTH OF SURFACE CASING	NUMBER OF ACRES IN DRILLING UNIT	DISTANCE FROM PROPOSED LOCATION TO NEAREST DRILLING UNIT LINE	DISTANCE FROM PROPOSED LOCATION TO NEAREST DRILLING, COMPLETED OR APPLIED FOR WELL	
FEET	FEET	ACRES	FEET	FEET	

NAME OF DRILLING CONTRACTOR

ADDRESS CITY STATE ZIP

FOR CHANGE OF OPERATOR ONLY - SIGNATURE OF FORMER OPERATOR REQUIRED FOR TRANSFER OF

AUTHORIZED REPRESENTATIVE SIGNATURE <i>[Signature]</i>	NAME OF FORMER OPERATOR Meason Operating Company
---	--

NOTE: AREA FIELD INSPECTOR OR FIELD DIRECTOR (JACKSON OFFICE) OF DATES OF SPUDDING AND REACHING TOTAL DEPTH.
 Mississippi State Oil and Gas Board, 500 Greymont Avenue, Suite E, Jackson, MS 39202 601-354-7142

REMARKS: (IF THIS IS AN APPLICATION TO WORKOVER, BRIEFLY DESCRIBE WORK TO BE DONE, GIVING PRESENT PRODUCING ZONE AND EXPECTED NEW PRODUCING ZONE)

Change of operator effective March 1, 2014

ARE THERE SEPARATELY OWNED TRACTS OR INTERESTS IN THE DRILLING UNIT FOR WHICH THIS PERMIT IS SOUGHT? (REF. MS. STATUTE 53-3-7)	YES	NO	IF YES, HAVE THE PERSONS OWNING THE DRILLING RIGHTS IN SAID TRACTS OR INTERESTS AND THE RIGHTS TO SHARE IN THE PRODUCTION THEREFROM AGREED TO DEVELOP THEIR LANDS AS A DRILLING UNIT AND TO THE DRILLING OF THE WELL? (REF. MS. STATUTE 53-3-7)	YES	NO
--	-----	----	---	-----	----

EXECUTED THIS THE 4th DAY OF March, 2014

STATE OF MISSISSIPPI
 COUNTY OF Adams

BEFORE ME, THE UNDERSIGNED AUTHORITY, ON THIS DAY PERSONALLY APPEARED Courtney Aldridge KNOWN TO ME TO BE THE PERSON WHOSE NAME IS SUBSCRIBED TO THE ABOVE INSTRUMENT, WHO BEING BY ME DULY SWORN ON OATH, STATES THAT HE IS DULY AUTHORIZED TO MAKE THE ABOVE REPORT AND THAT HE HAS KNOWLEDGE OF THE FACTS STATED THEREIN, AND THAT SAID REPORT IS TRUE AND CORRECT.

SUBSCRIBED AND SWORN TO BEFORE ME THIS 4th DAY OF March, 2014

SEAL

MY COMMISSION EXPIRES 10-10-16

SIGNATURE OF AFFIANT [Signature]

SIGNATURE [Signature]
 NOTARY PUBLIC IN AND FOR Adams COUNTY Mississippi

PERMIT NUMBER 2014-COP-0112

APPROVAL DATE APR 09 2014

APPROVED BY [Signature]

MISSISSIPPI STATE OIL AND GAS BOARD FORM 2 (Rev. 5/10) A. P. I. WELL NUMBER		
STATE	COUNTY	WELL

NOTICE: BEFORE SENDING THIS FORM, BE SURE THAT ALL INFORMATION REQUESTED IS GIVEN. SEE INSTRUCTIONS ON REVERSE SIDE OF FORM.

RECEIVED
MAR 10

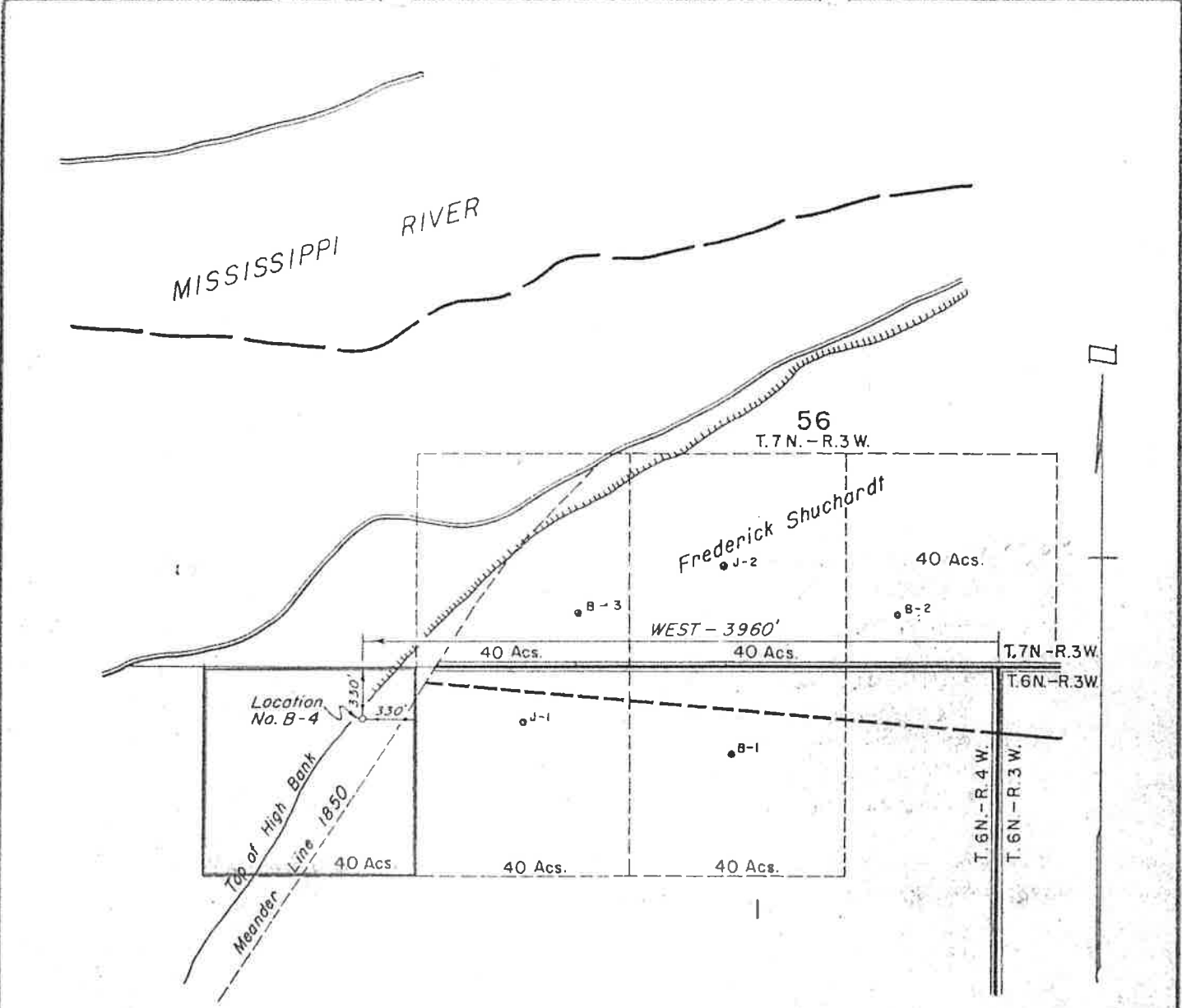

WELL LOCATION
FOR
BILLUPS BROTHERS
AND
SUNNYLAND CONTRACTING CO., INC.
TOWNSHIP 6 NORTH-RANGE 4 WEST
ADAMS COUNTY, MISSISSIPPI
BY
ENGINEERING SERVICE - JACKSON, MISSISSIPPI

DRILLING UNIT: _____

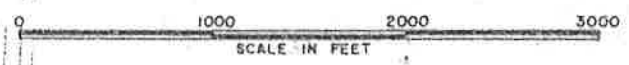
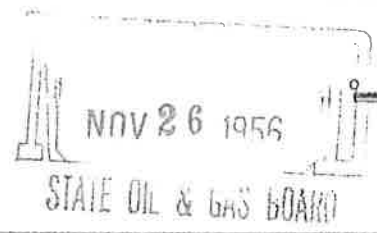

NOVEMBER, 1956

MISSISSIPPI OIL AND GAS BOARD

NOTICE OF INTENTION TO DRILL

(Permit Fee - \$25.00)

INSTRUCTIONS

Notice must be filed in duplicate on every well. Do not begin operations on any location until approval from the Board has been received. Approved duplicate copy of this notice will be returned to the applicant. It is mandatory that the proposed location covered by this notice conform to the spacing rules of the Board. Attach a certified plat or sketch drawn to the scale of one inch equalling 1000 feet, locating thereon all previously drilled and drilling wells and proposed location with reference to the two nearest lease and/or drilling unit lines, or sketch may be drawn on the reverse side of this form. On plat show distance between two points farthest removed apart on drilling unit.

GIVE LEGAL DESCRIPTION OF UNIT ON THE BACK OF THIS FORM OR ATTACH TO APPLICATION.
Refer to Statewide Rule No. 11 for surface casing requirements.

IMPORTANT—SEE REVERSE SIDE

Name Billups Brothers and Sunnyland Contracting Co., Inc. Date November 23 19 56
(Operator)

Address Box 388 City Rayne State Louisiana

DESCRIPTION OF FARM OR LEASE

Name (Fee Owner) Frederick Schuchardt Well No. B-4

Exact Location of Well From the northeast corner of T 6 N - R 4 W, Adams County, Mississippi
go West for 3960.0 feet; Thence South for 330.0 feet to location.

Sec. _____ Twp. 6 N Range 4 W County Adams

Name of Field North Carthage Point Wildcat _____

Nearest distance from proposed location to drilling unit line 330 feet.

Distance from proposed location to nearest drilling, completed, permitted or applied for well over 660 feet.

Proposed drilling depth 6100 feet. Proposed Length of Surface Casing 490 feet.

Check the type of proposed well Oil Gas _____ Other _____
(Name)

Does proposed well location conform to all laws, rules and regulations as to size and shape of drilling unit and footage from lease or drilling unit lines. Yes

Name rule or regulation governing location of the well and size of the drilling unit _____

Statewide Rule 7 Acres in Drilling Unit 40
(Statewide Rule 7 for oil or Rule 8 for gas, Field or Special Exception)

Name of Drilling Contractor Sunnyland Contracting Co., Inc.

Address Box 388 City Rayne State Louisiana

AFFIDAVIT:

James T. Gibson, being first duly sworn on oath, state that I have knowledge of the facts and matter herein set forth and that the same are true and correct.

Name James T. Gibson Title Surveyor

Subscribed and sworn to before me this 23rd day of November 19 56

My Commission Expires June 7, 1960

Permit No. 214

Action of Board _____

Date Approved 11-27-56

Notary Public, County of Hinds State Miss.

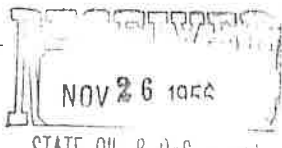

MISSISSIPPI OIL AND GAS BOARD

By J. M. Morse

MISSISSIPPI OIL AND GAS BOARD

WELL COMPLETION REPORT (File in Duplicate)

Permit No. 214

OPERATOR Sunnyland Contracting Co., Inc. FIELD North Carthage Point
 STREET P. O. Box 388 POOL _____
 CITY Rayne, STATE Louisiana COUNTY Adams
 LEASE NAME Frederick Schuchardt WELL No. B-4 ACRES IN UNIT 40
 LOCATION From the Northeast Corner of T-6-N; R-4-W, Adams County, Mississippi, go west
for 3960'; Thence South for 330' to location SEC. - TWP. 6-N RGE. 4-W
 ELEVATION DF 77' GR. 68' DATE SPUDDED Dec. 11, 19 56 COMP. DATE Dec. 26, 19 56
 TOTAL DEPTH WELL 5,930' FINAL ELECTRICAL LOG TO 5,914' DATE RUN Dec. 17, 19 56
 NUMBER OF CRUDE OIL PRODUCING WELLS ON THIS LEASE, INCLUDING THIS WELL Six

OFFICIAL COMPLETION GAUGE

Date Test Commenced 7 A.M. Dec. 29, 19 56 Completed 7 A.M. Dec. 30, 19 56
 Produced 104 barrels of oil in 24 hours - - minutes
 At the rate of 104 net bbls. oil per 24 hours plus 1/10 of 1 % BS&W
 API Gravity @ 60° F. 45.4 Gas/Oil Ratio 200/1 (Cu. Ft. Per Net Bbl. Oil)

For Flowing Well:

Flowing Pressure: Tbg. 230 psi Csg. 145 psi
 Choke diam. 9/64 in. Type Positive Length 8 in.
 Shut-in tbg. Pr. 300 psi. If gas lift, number gas valves
 used None Cu. Ft. Gas Per Net Bbl. Oil 200/1
 If tubing packer used, set at - - - ft.

For Pumping Well:

Length of Stroke - - in.
 Strokes per min. - -
 Diam. working bbl. - - in.
 Pumping depth - -

If completed in open hole, net pay open to production from - - - to - - -

Name of Pipe Line or other carrier Interstate Oil Pipe Line Company

If gas well, Form 4 must be filed in addition to Form 3.

CASING, LINER AND TUBING RECORD

String	Size	Wt./Ft.	Grade	No. Jts.	Name and Type	Ami. Ft.	Depth Set
Surface	8-5/8"	24.00	J-55	16	Natl. API Smls	505.00'	515.00'
Production	5-1/2"	15.50	J-55	169	Natl. API Smls	5,917.80'	5,930.00'
Tubing	2-1/2"	6.50	J-55	134	Natl. API Smls	4,018.00'	4,030.20'

CEMENT AND TESTING RECORD

Hole Size	String	Where Cement Placed	No. Skts.	Type Cement	Pr. Applied In Testing
12-1/4"	8-5/8"	515.00'	200	Common	600#
7-7/8"	5-1/2"	5,930.00'	200	Common	1200#

PERFORATING, CHEMICAL AND EXPLOSIVE RECORD

Date	Type and Size of Shot, Chemical or Explosive	Quantity (No. shots, gals. or qts.)	From	To
12-23-56	1/2" bullet; 4" S. C.	5	5,856.5'	5,857.9'
12-24-56	1/2" bullet; 2-3/16" S. C.	12	5,838.5'	5,841.5'

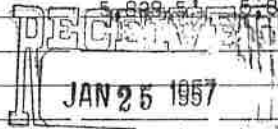

AFFIDAVIT

STATE OIL & GAS BOARD

I, Daniel E. LeLeux, being first duly sworn on oath state that I have knowledge of the facts and matter herein set forth and that, the same are true and correct.

SUNNYLAND CONTRACTING CO., INC.
 By [Signature]
 Representative of Operator

Secty.-Treas. _____, Title

Subscribed and sworn to before me, this 22nd day of January, 19 57

[Signature]
[Title]

